

4

3

2

1

REVISIONS		
REV	DESCRIPTION	CO
1	PRODUCTION RELEASE	-
		-

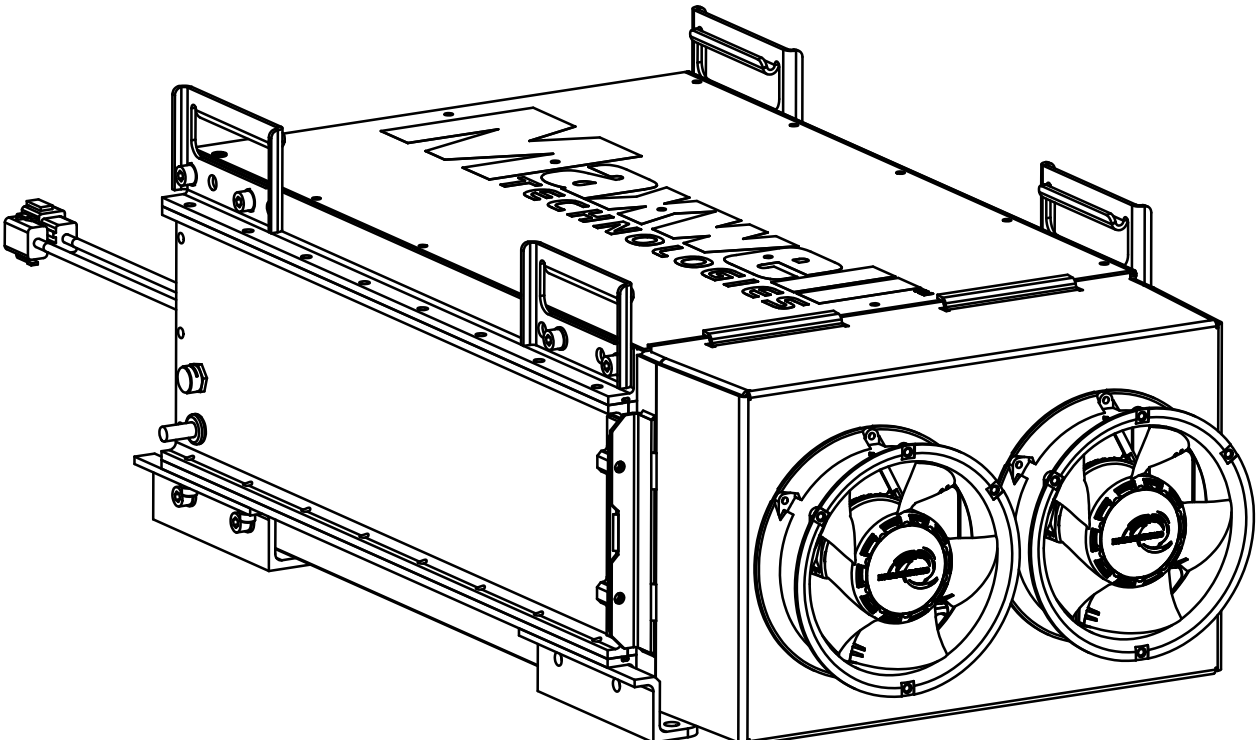
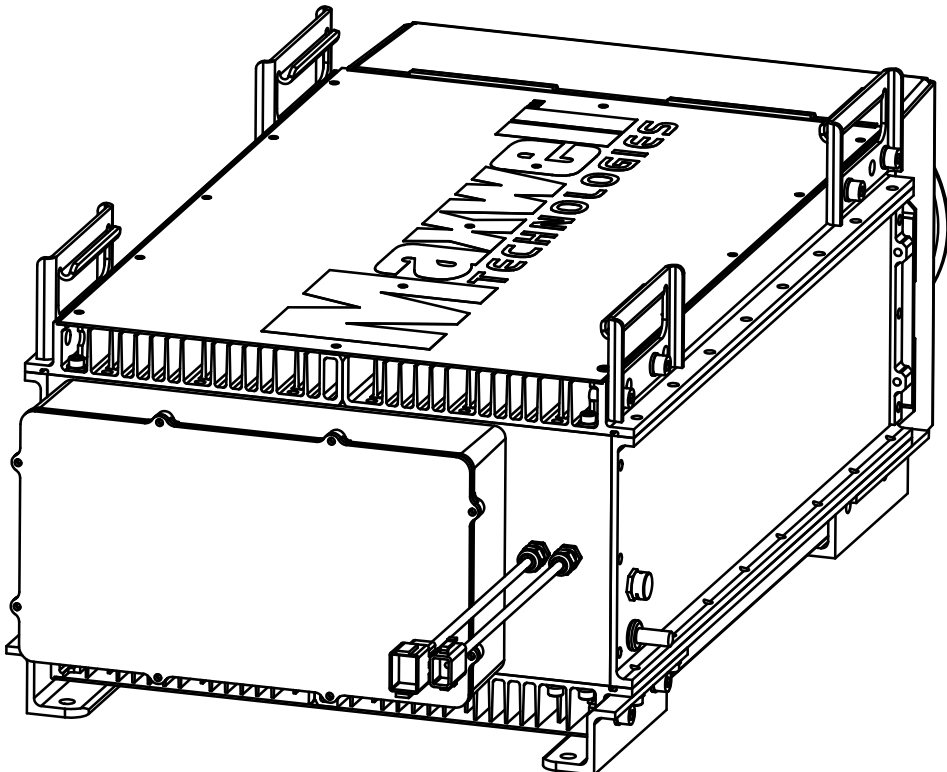

<p>NOTICE: THE INFORMATION CONTAINED IN THIS DOCUMENT IS MAXWELL CONFIDENTIAL INFORMATION AND IS THE SOLE PROPERTY OF MAXWELL TECHNOLOGIES. ANY REPRODUCTION IN PART OR WHOLE WITHOUT WRITTEN PERMISSION OF MAXWELL TECHNOLOGIES IS PROHIBITED.</p> <p>3RD ANGLE PROJECTION</p>	<p>DO NOT SCALE DRAWING UNLESS OTHERWISE SPECIFIED, ALL DIMENSIONS ARE IN MILLIMETERS AFTER PLATING.</p>	<p>APPROVALS</p> <p>DRAWN J.KUELKER</p> <p>CHECKED</p> <p>DESIGN ENGR</p> <p>MECHANICAL ENGR</p> <p>PROCESS ENGR</p> <p>TEST ENGR</p> <p>QUALITY ENGR</p> <p>PRODUCTION ENGR</p>	<p>DATE</p> <p>1/16/2009</p>	<p>Maxwell TECHNOLOGIES</p> <p>9244 BALBOA AVENUE, SAN DIEGO, CA 92123 U.S.A</p>
	<p>MATERIAL</p> <p>N/A</p> <p>FINISH</p> <p>N/A</p>	<p>DESCRIPTION</p> <p>SCD, MODULE 125V HTM, 2.2</p>	<p>SIZE</p> <p>B</p> <p>CAGE CODE</p> <p>68911</p> <p>PART NO.</p> <p>N/A</p>	
<p>CAUTION CONTAINS PARTS AND/OR ASSEMBLIES SUSCEPTIBLE TO DAMAGE BY ELECTROSTATIC DISCHARGE (ESD)</p>				<p>SCALE</p> <p>1:7</p> <p>DOC. NO.</p> <p>1014553</p> <p>REV</p> <p>1</p> <p>SHEET</p> <p>1 OF 5</p>

REFERENCE IFS FOR APPROVAL AND APPROVAL DATES

4

3

2

1

D

D

C

C

B

B

A

A

NOTICE: THE INFORMATION CONTAINED IN THIS DRAWING IS THE SOLE PROPERTY OF MAXWELL TECHNOLOGIES INC. ANY REPRODUCTION IN PART OR WHOLE WITHOUT WRITTEN PERMISSION OF MAXWELL TECHNOLOGIES IS PROHIBITED

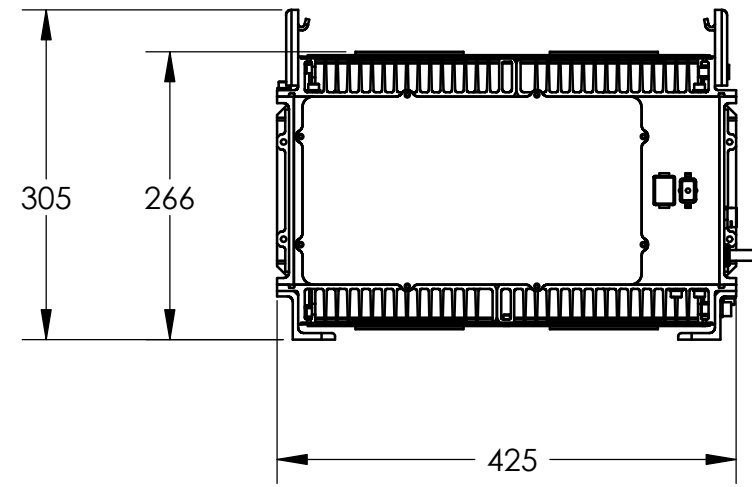

125V HTM COMPLETE

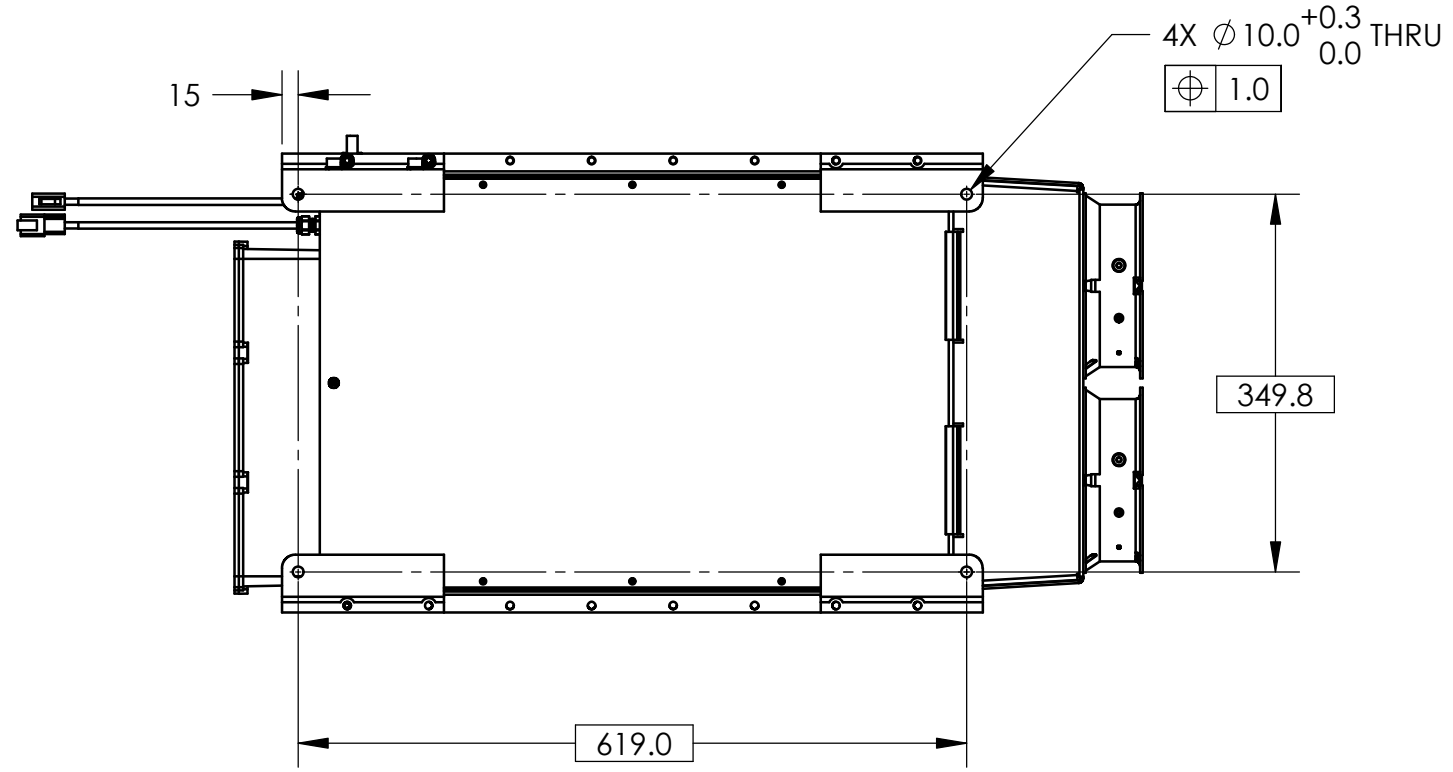
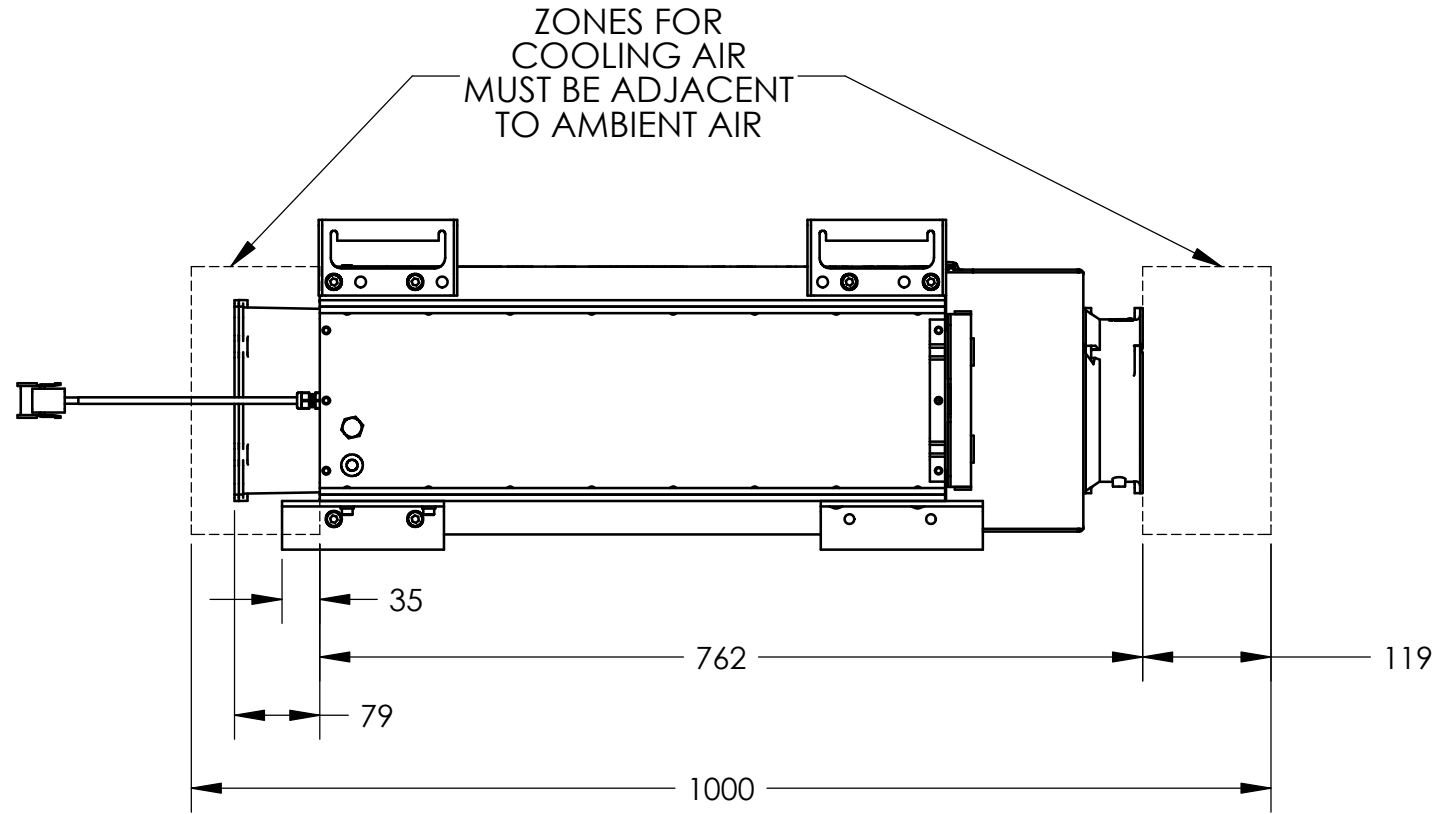

SIZE B	CAGE CODE 68911	PART NO. N/A	REV -
SCALE 1:7	DOC. NO. 1014553	REV 1	SHEET 2 OF 5

NOTICE: THE INFORMATION CONTAINED IN THIS DRAWING IS THE SOLE PROPERTY OF MAXWELL TECHNOLOGIES INC. ANY REPRODUCTION IN PART OR WHOLE WITHOUT WRITTEN PERMISSION OF MAXWELL TECHNOLOGIES IS PROHIBITED

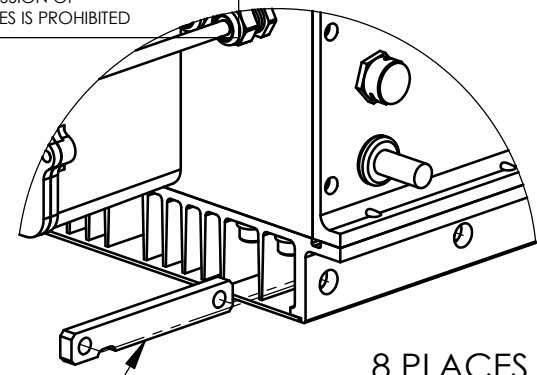

8 PLACES
DETAIL G
SCALE 1 : 3

NUT PLATE

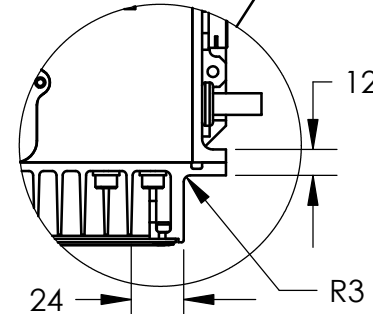
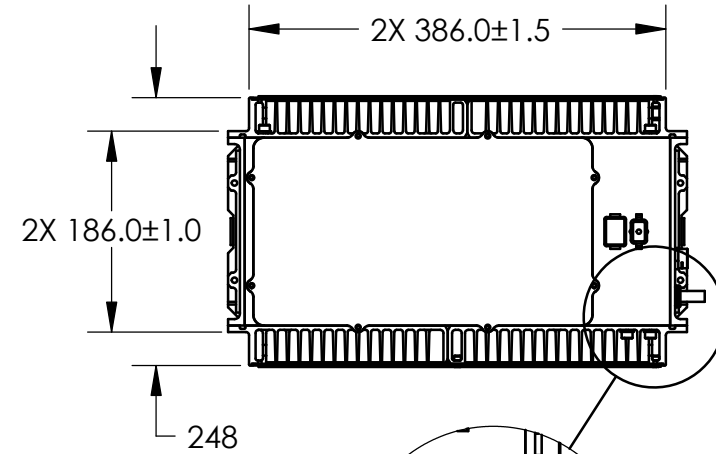

8 PLACES
DETAIL J
SCALE 2 : 7

125V HTM 2.2 WITHOUT HANDLES & FEET

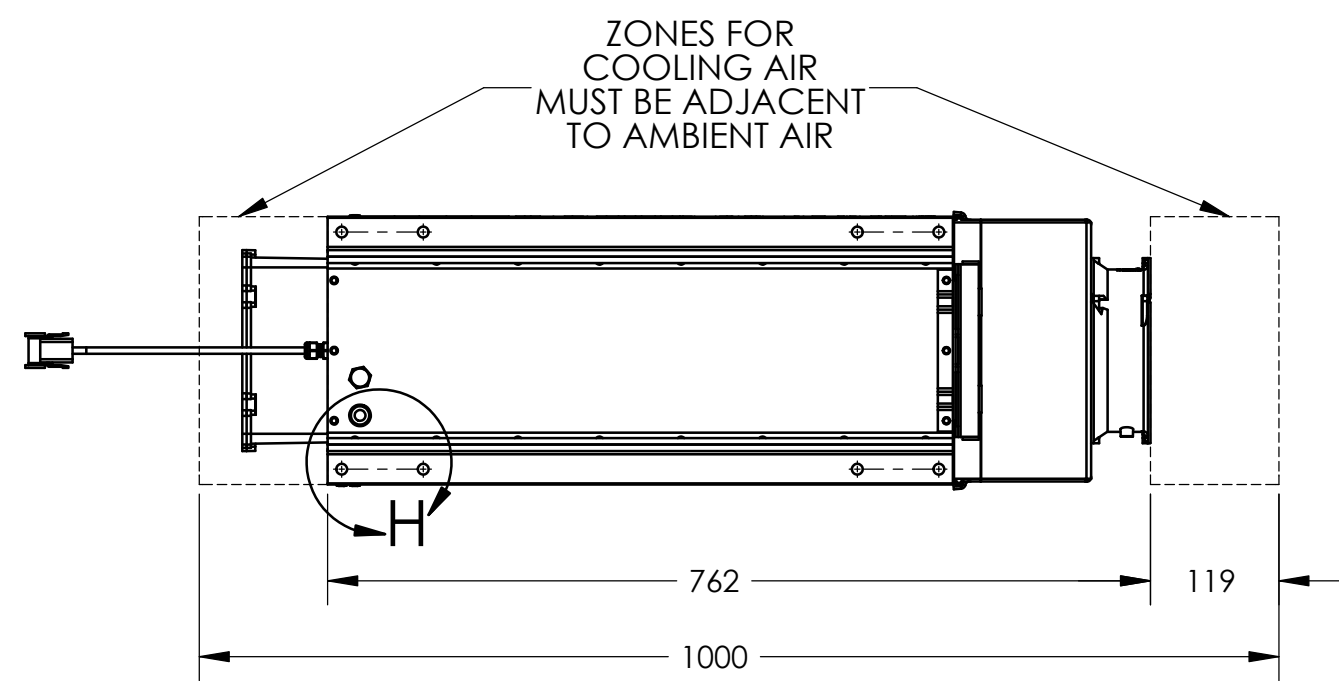
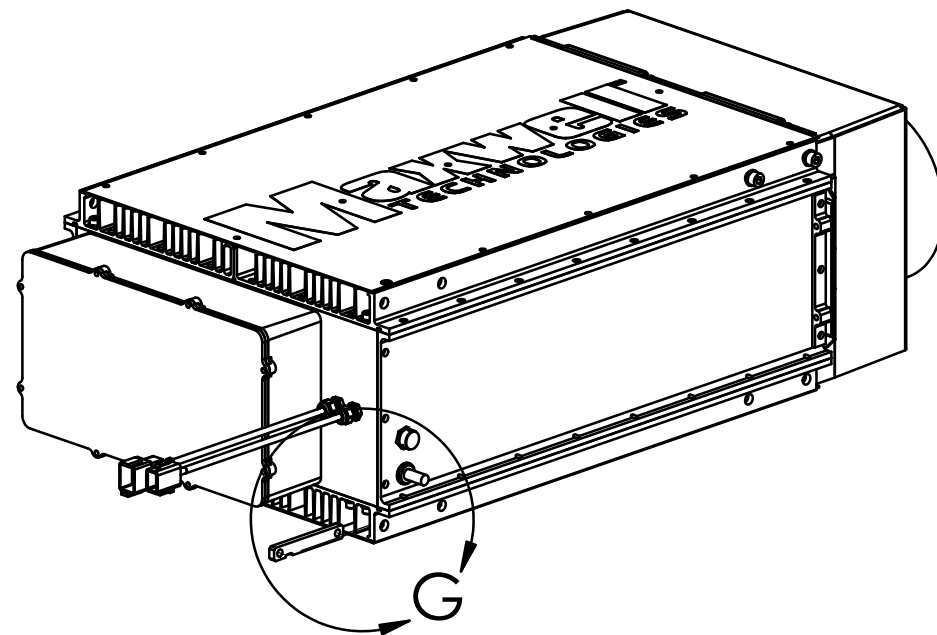

ZONES FOR COOLING AIR MUST BE ADJACENT TO AMBIENT AIR

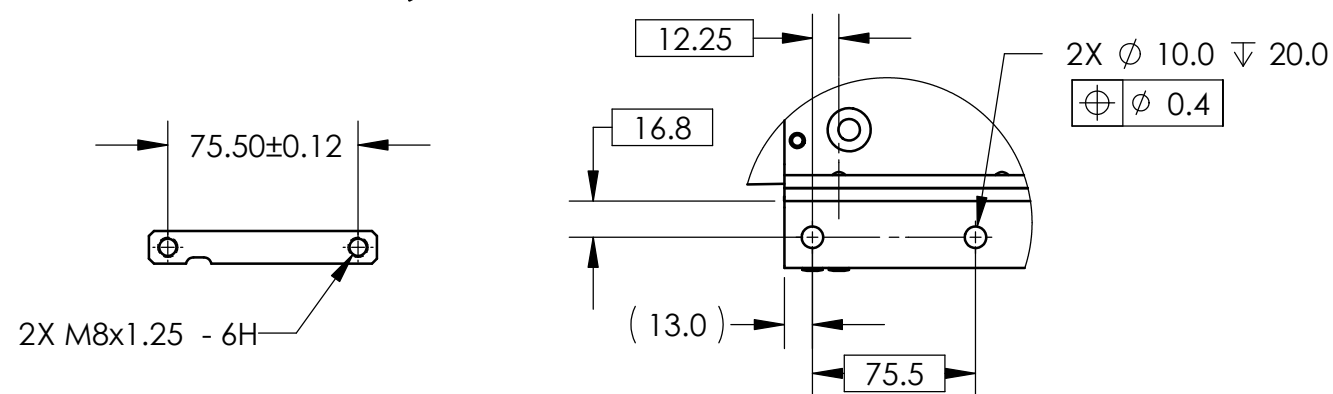
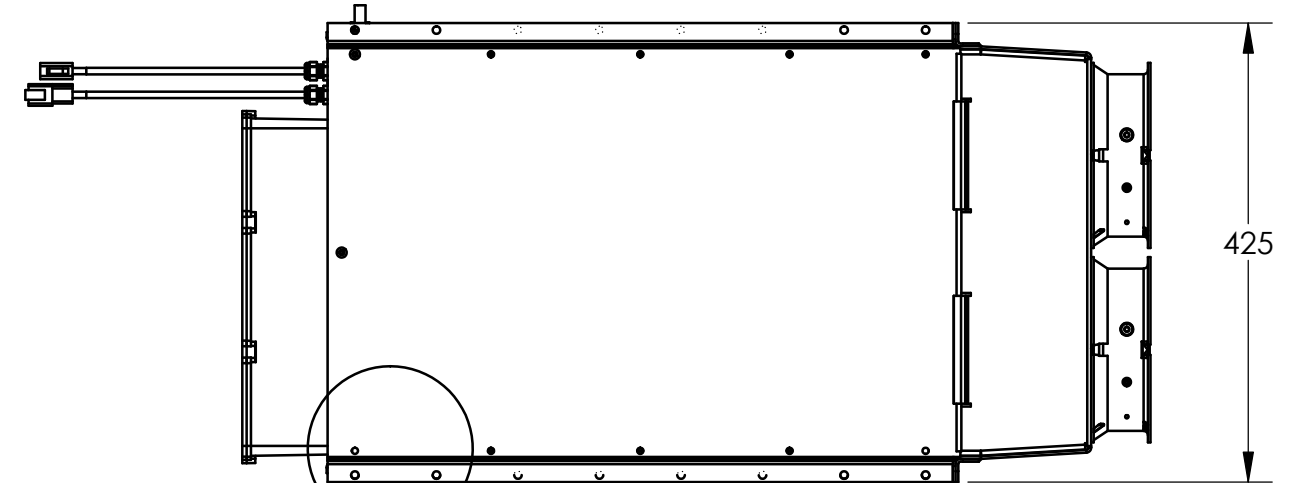

8 PLACES
DETAIL H
SCALE 2 : 7

2X M8x1.25 - 6H

NUT PLATE

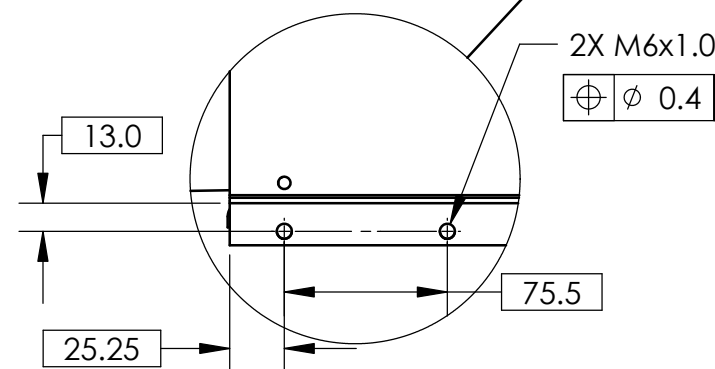

8 PLACES
DETAIL D
SCALE 2 : 7

NOTE: REMOVAL OF MAXWELL MOUNTING FEET VOIDS WARRANTY. PLEASE REFER TO MANUAL FOR WARRANTY COVERAGE.

- MAXWELL MOUNTING RECOMMENDATIONS:
- USE 4 SCREWS AT EACH ATTACHMENT CORNER: (2x M6- 1.0 AND 2x M8-1.25)
 - USE CLASS 12.9 HARDWARE
 - TORQUE M8 & M6 SCREWS TO 28 & 11 N-m
 - USE LOCKWASHERS AND LOCTITE 272 OR EQUIV.

SIZE B	CAGE CODE 68911	PART NO. N/A	REV -
SCALE 1:7	DOC. NO. 1014553	REV 1	SHEET 3 OF 5

NOTICE: THE INFORMATION CONTAINED IN THIS DRAWING IS THE SOLE PROPERTY OF MAXWELL TECHNOLOGIES INC. ANY REPRODUCTION IN PART OR WHOLE WITHOUT WRITTEN PERMISSION OF MAXWELL TECHNOLOGIES IS PROHIBITED

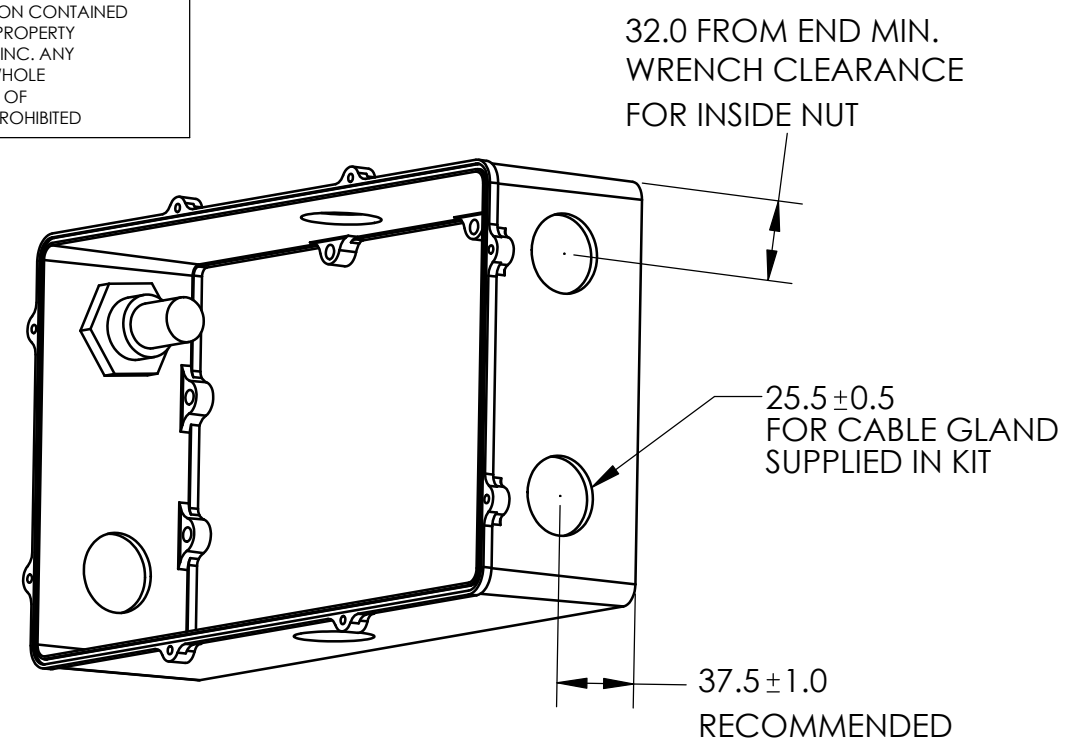

JUNCTION BOX DRILLING DIMENSIONS

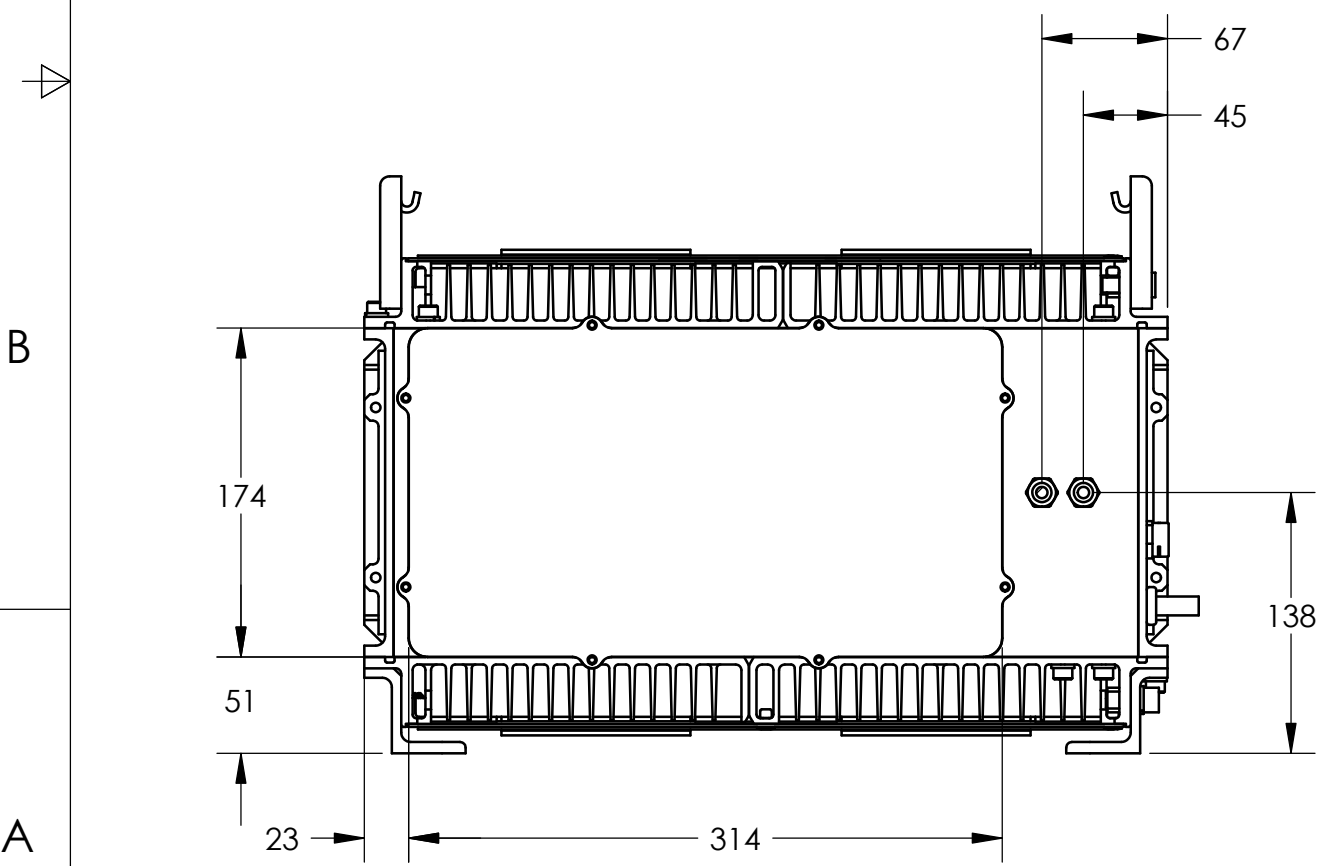
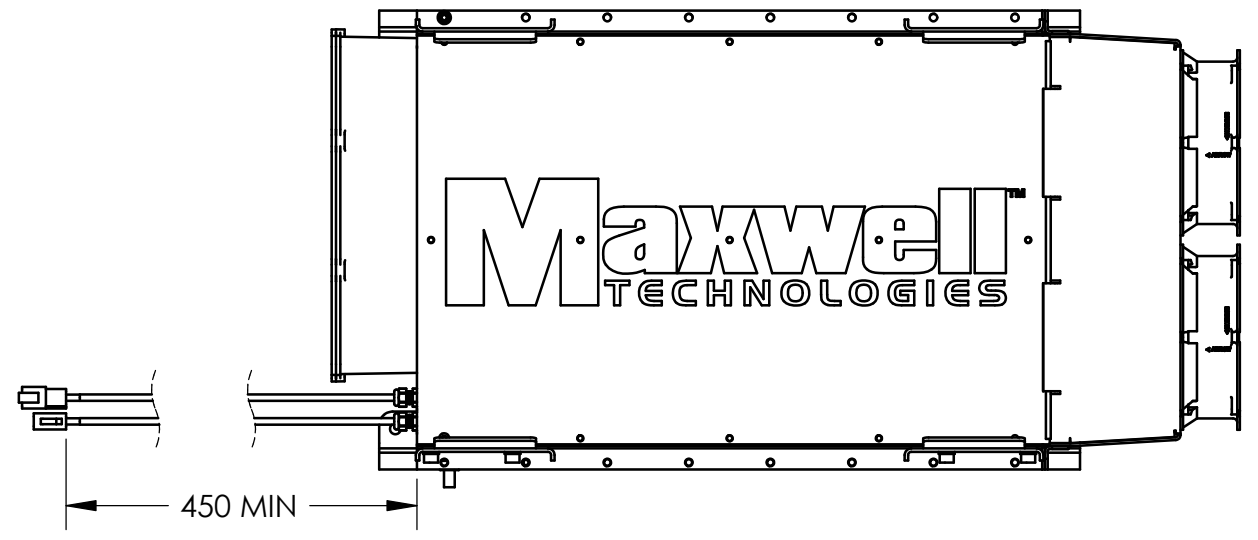

SECTION C-C
SCALE 1 : 4

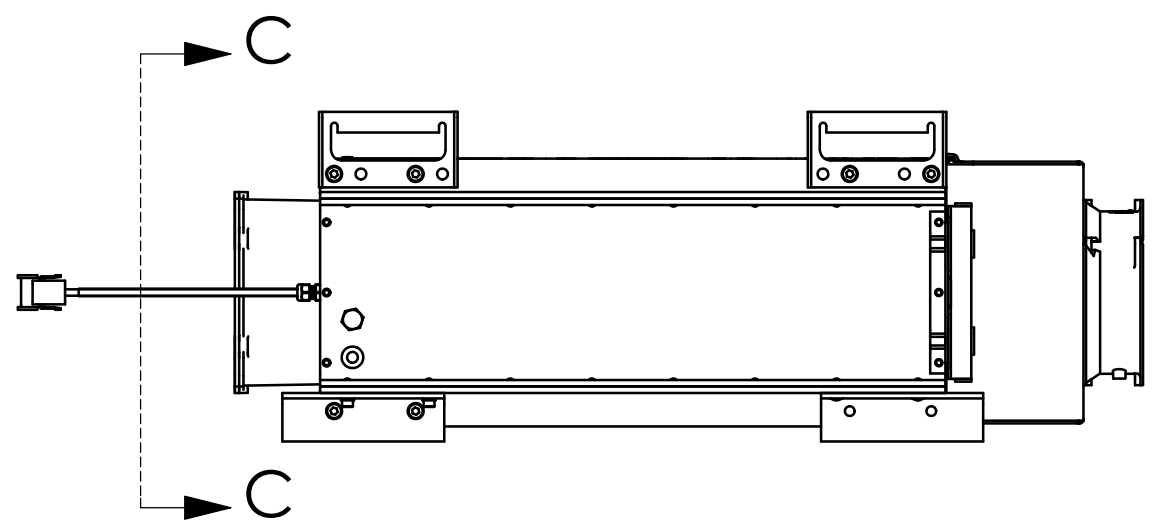

JUNCTION BOX AND CABLE DIMENSIONS

SIZE B	CAGE CODE 68911	PART NO. N/A	REV -
SCALE 1:10	DOC. NO. 1014553	REV 1	SHEET 4 OF 5

NOTICE: THE INFORMATION CONTAINED IN THIS DRAWING IS THE SOLE PROPERTY OF MAXWELL TECHNOLOGIES INC. ANY REPRODUCTION IN PART OR WHOLE WITHOUT WRITTEN PERMISSION OF MAXWELL TECHNOLOGIES IS PROHIBITED

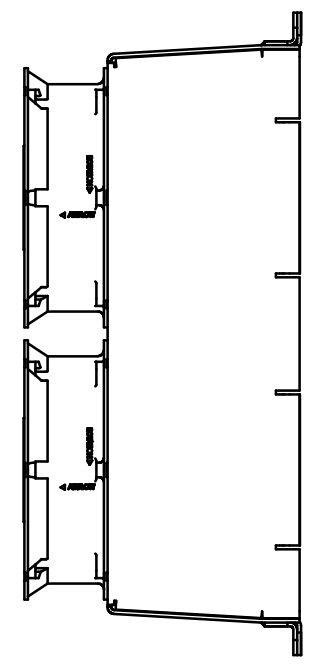
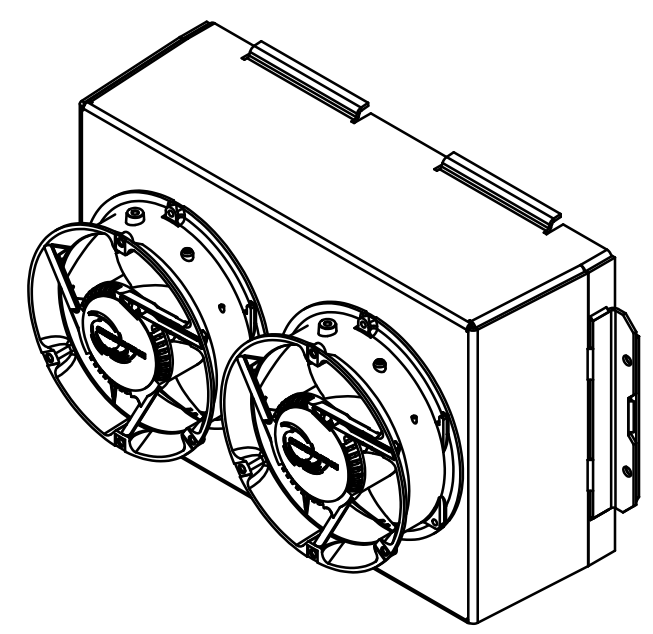
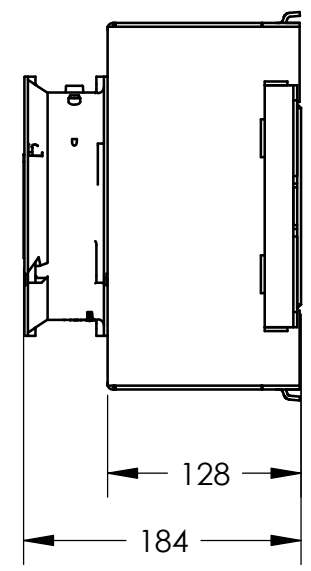
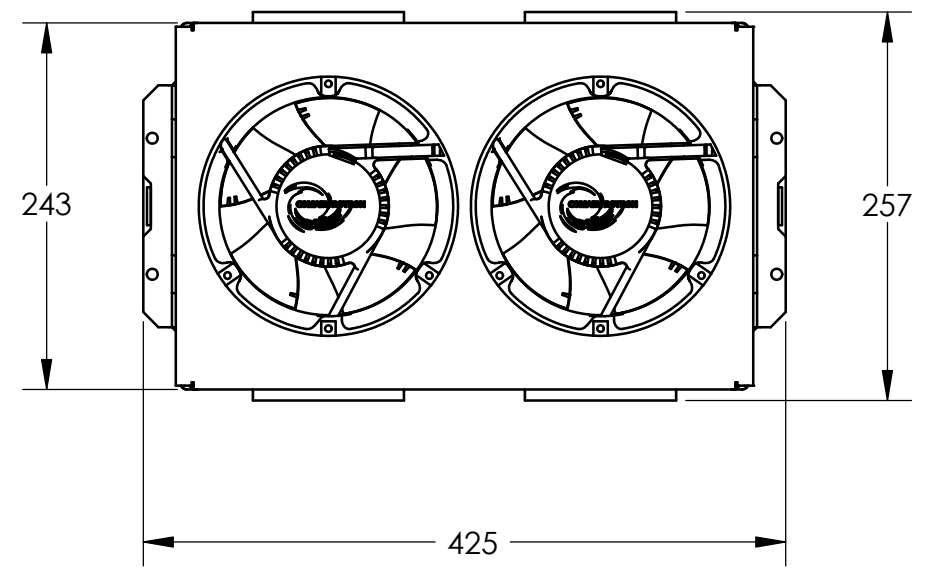

125V HTM 2.2 FAN SHROUD ASSEMBLY

SIZE B	CAGE CODE 68911	PART NO. N/A	REV -
SCALE 1:8	DOC. NO. 1014553	REV 1	SHEET 5 OF 5